

N Jack (Female) Connector Solder Attachment 4 Hole Flange Mount for .141 Cable
DC-11 GHz VSWR 1.2

N2EBF50-EZ141C / 93

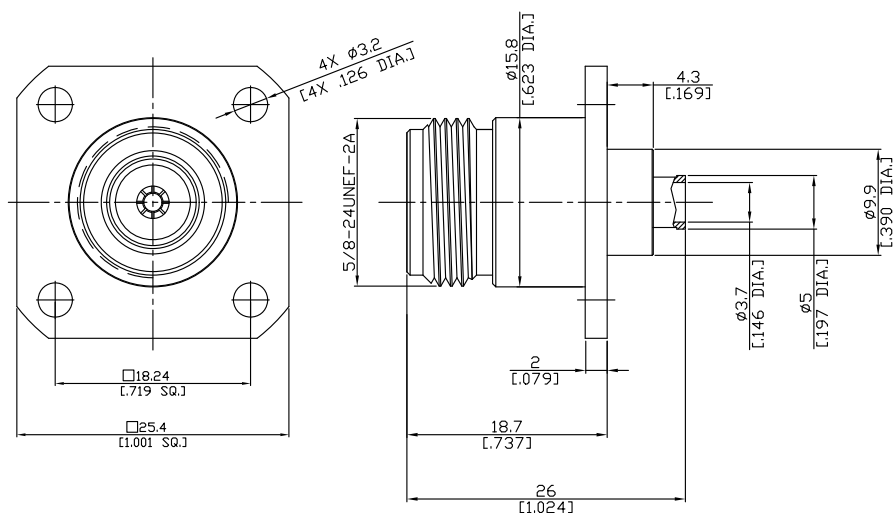

Mounting Dimension

	mm		inch	
	Max.	Min.	Max.	Min.
A	16.3	16.1	.642	.634
B	3.30	3.20	.130	.126
C	18.35	18.15	.722	.715

All dimensions are in mm [inch]

Tolerances according to DIN ISO 2768-mH

Interface

According to

IEC 60169-16; MIL-STD-348/304; CECC 22 210

Electrical Data

Impedance	50 Ω	
Frequency	DC to 11 GHz	
VSWR (Return Loss)	≤ 1.2 (≥ 20.83 dB)	
Insertion Loss	≤ 0.1 x √F (GHz) dB	
Insulation Resistance	≥ 5 x 10 ³ MΩ	
Center Contact Resistance	≤ 1 mΩ	
Outer Contact Resistance	≤ 0.25 mΩ	
Working Voltage (at sea level)	500 V rms	
Power handling	1000 W @ 1 GHz	700 W @ 2 GHz
RF-leakage	≥ 128 dB up to 1 GHz	

-VSWR in application depends decisive on cable assembly process-

Material And Plating

Connector parts	Material	Plating
Centre contact	Beryllium Copper	Gold plating, 3 pinch (Non-magnetic nickel-phosphorus underplating, 100 pinch)
Body	Brass	Nickel
Insulator	PTFE	

N Jack (Female) Connector Solder Attachment 4 Hole Flange Mount for .141 Cable
DC-11 GHz VSWR 1.2

N2EBF50-EZ141C / 93

Mechanical Data

Coupling mechanisms	Screw-lock
Mating Cycles	min. 500
Centre Contact	Plug-in
Cable entry	Soldered
Center Contact Captivation: axial	≥ 28 N
radial	≥ 3 Ncm
Coupling Test Torque	max. 1.7 Nm
Recommended Torque	0.7 Nm to 1.1 Nm

Environmental Data

Temperature Range	-55°C to +155°C
Thermal shock	MIL-STD-202, Meth. 107, Cond. B
Corrosion	MIL-STD-202, Meth. 101, Cond. B
Vibration	MIL-STD-202, Meth. 204, Cond. B
Shock	MIL-STD-202, Meth. 213, Cond. I
Moisture Resistance	MIL-STD-202, Meth. 106
RoHS	compliant

Suitable Cables

.141 RSF, .141 RSR, RG402, EF402

Packing

Single or 100