

**N (Female) Straight Cable Jack,
DC to 6 GHz, VSWR ≤ 1.22**

N2C50-G316A/H3

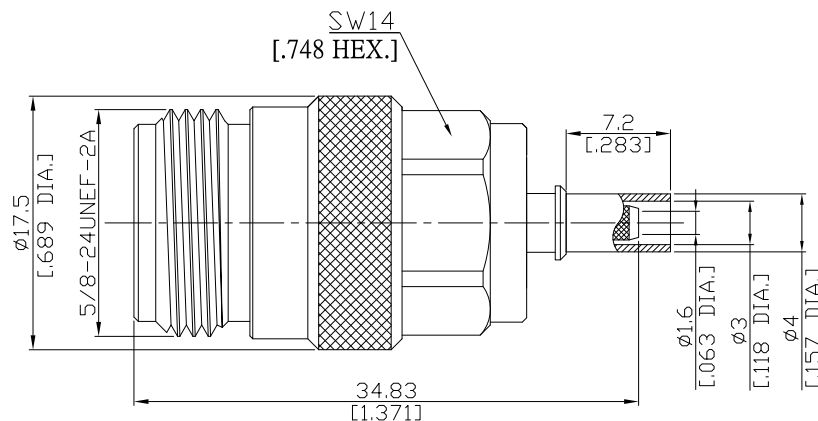

All dimensions are in mm [inch]

Tolerances according to DIN ISO 2768-mH

Interface

According to IEC 60169-16; MIL-STD-348A/304

Electrical Data

Impedance 50 Ω
Frequency DC to 6 GHz
VSWR (Return Loss) ≤ 1.22 (≥ 20.1 dB)
Insertion Loss ≤ 0.05
Working voltage (at sea level) 900 V rms

- Limitations are possible due to the used cable type and manufacturing method -

Mechanical Data

Coupling mechanisms Screw-lock
Centre contact Soldered or Crimped
Cable entry Crimped

Environmental Data

Temperature range -65°C to +165°C
RoHS compliant

Material And Plating

Connector parts	Material	Plating
Centre contact	Phosphor Bronze	Gold plating(Nickel underplated)
Body	Brass	Nickel
Insulator	PTFE	
Crimp ferrules	Brass	Nickel

Suitable Cables

RG-174, RG-188A, RG-316, BEIDEN 7805

Packing

Single or 100



**N (Female) Straight Cable Jack,
DC to 6 GHz, VSWR ≤ 1.22**

N2C50-G316A/H3

Recommended Cable Stripping Dimensions

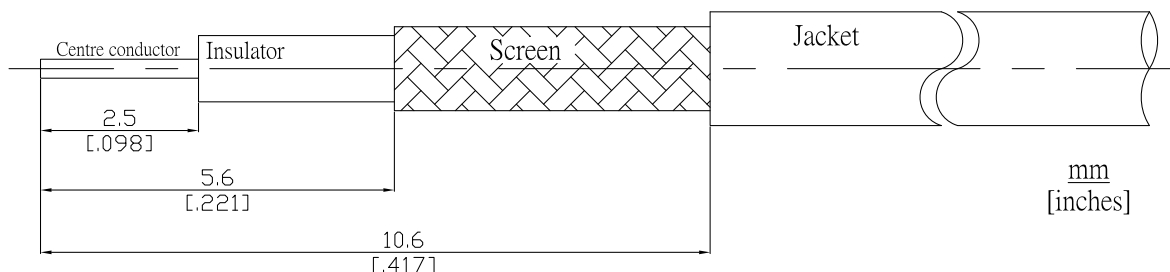

Crimp Dimensions

Crimp ferrule	3.25 mm [.128 inch] HEX
Center Contact	0.7 mm [.028 inch] SQ