

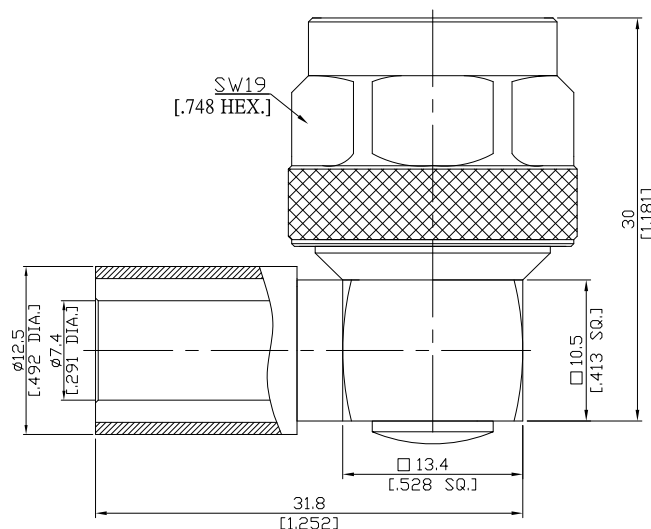

N Right Angle Cable Plug

N1C59-G008A/133



All dimensions are in mm [inch]

Tolerances according to DIN ISO 2768-mH

**Interface**

According to

IEC 60169-16; MIL-C-39012; MIL-STD-348A/304

**Electrical Data**

Impedance

50  $\Omega$

Frequency

DC to 18 GHz

VSWR (Return Loss)

$\leq 1.22$  ( $\geq 20.1$  dB), DC to 11 GHz

Insertion Loss

$\leq 0.05$  dB

- Limitations are possible due to the used cable type -

**Mechanical Data**

Coupling mechanisms

Screw-lock

Centre contact

Soldered

Cable entry

Crimped

**Environmental Data**

Temperature range

-65°C to +165°C

RoHS

compliant

**Material And Plating**

Connector parts	Material	Plating
Centre contact	Brass	Gold plating(Nickel underplated)
Body	Brass	Nickel
Insulator	PTFE	
Gasket	Silicone Rubber	
Coupling nut	Brass	Nickel
Crimp ferrules	Brass	Nickel

**Suitable Cables**

RG-8, RG-8A, RG-9, RG-87A, RG-215

**Packing**

Single or 100