

N Plug (Male) Connector Crimp Cable Entry, Solder or Crimp Center Contact Attachment
for RNL400, LMR-400 Series, Belden 7810A, 8214, 9913, Ecoflex 10
DC-6GHz VSWR1.30

N1C50-R400B / 144

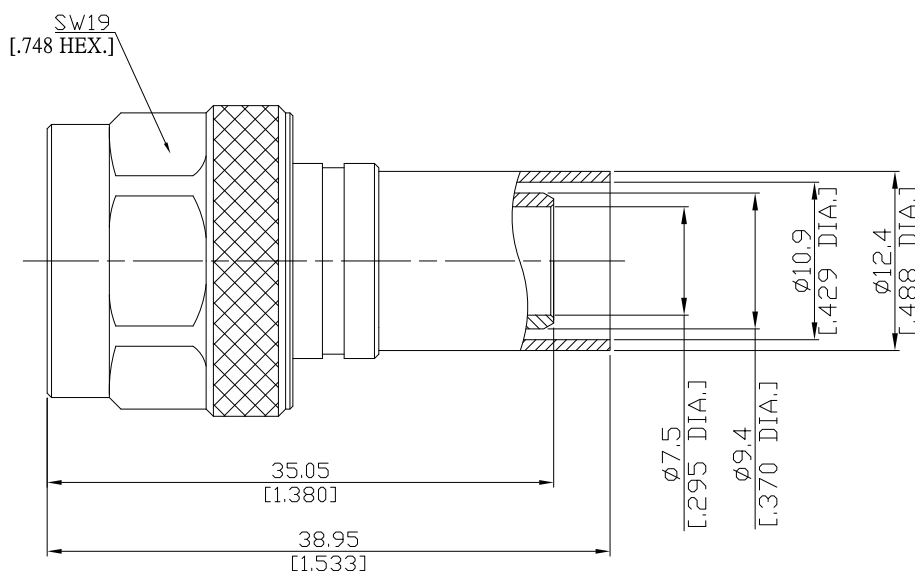

All dimensions are in mm [inch]

Tolerances according to DIN ISO 2768-mH

Interface

According to

IEC 61169-16

MIL-STD-348B/304

Electrical Data

Impedance	50 Ω
Frequency	DC to 6 GHz
VSWR (Return Loss)	≤ 1.30 (≥ 17.69 dB)
Insertion Loss	≤ 0.05 × √F (GHz) dB
Insulation Resistance	≥ 5 GΩ
Center Contact Resistance	≤ 1.0 mΩ
Outer Contact Resistance	≤ 0.25 mΩ
Working Voltage (at sea level)	500 V rms
Power Handling (at 20 °C, sea level, VSWR 1.0)	1000 W @ 1 GHz

700 W @ 2 GHz

- Limitations are possible due to the used cable type -

Material And Plating

Piece Parts	Material	Plating
Centre contact	Brass	Gold plating, 3 μinch (Non-magnetic nickel-phosphorus underplating, 80 μinch)
Body	Brass	Copper-Tin-Zinc Alloy
Insulator	PTFE	
Gasket	Silicone rubber	
Coupling nut	Brass	Copper-Tin-Zinc Alloy
Crimp ferrule	Brass	Copper-Tin-Zinc Alloy

N Plug (Male) Connector Crimp Cable Entry, Solder or Crimp Center Contact Attachment
for RNL400, LMR-400 Series, Belden 7810A, 8214, 9913, Ecoflex 10
DC-6GHz VSWR1.30

N1C50-R400B / 144

Mechanical Data

Coupling mechanisms	Screw-lock
Mating Cycles	≥ 500
Centre Contact	Soldered or Crimped
Cable Entry	Crimped
Coupling Test Torque	1.7 Nm max.
Recommended Torque	1.36 Nm

Environmental Data

Temperature Range	-65°C to +155°C
Thermal shock	MIL-STD-202, Meth. 107, Cond. B
Corrosion	MIL-STD-202, Meth. 101, Cond. B
Vibration	MIL-STD-202, Meth. 204, Cond. B
Shock	MIL-STD-202, Meth. 213, Cond. I
Moisture Resistance	MIL-STD-202, Meth. 106
RoHS	compliant

Suitable Cables

RNL400, LMR-400 Series, Belden 7810A, 8214, 9913, Ecoflex 10

Packing

Single or 100

N Plug (Male) Connector Crimp Cable Entry, Solder or Crimp Center Contact Attachment
for RNL400, LMR-400 Series, Belden 7810A, 8214, 9913, Ecoflex 10
DC-6GHz VSWR1.30

N1C50-R400B / 144

Connector Type:	N1C50-R400B/144	Inner Conductor Contact:	Soldered or Crimped
Suitable Cable:	RNL400, LMR400 Series, Belden 7810A, 8214, 9913, Ecoflex 10	Outer Conductor Contact:	Crimped

Parts List of Connector:

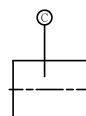
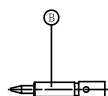
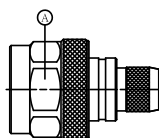

Crimped Ferrule
HEX. Crimp Size:



Crimped Contact Pin
HEX. Crimp Size:

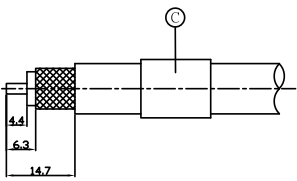
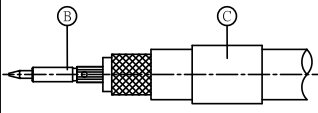
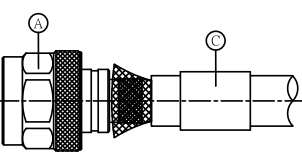
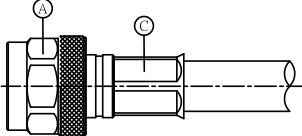

Assembly Steps:

Picture	Process	Attention/Check	Tools Required
	Push ferrule "C" over the cable. Prepare the cable according to the diagram.	Do not damage center contact, dielectric and braid.	Blade Scissor
	Push contact "B" over inner conductor of cable up to cable dielectric and crimp.	Contact "B" flush to dielectric.	Crimp tool: CT-L3 Crimp insert: CHL33KA
	Splay out braid and insert cable in connector body "A".	Ensure that braid lies above crimp neck.	
	Slide ferrule "A" over braid and crimp.	Crimp as close to connector body "C" as possible.	Crimp tool: CT-L3 Crimp insert: CHL33KA