

N Plug (Male) Connector Crimp/Contact Pin Solder or Crimp Attachment
for RG214, RG9, RG225, RG393 DC-6GHz VSWR1.22

N1C50-G214A / 144

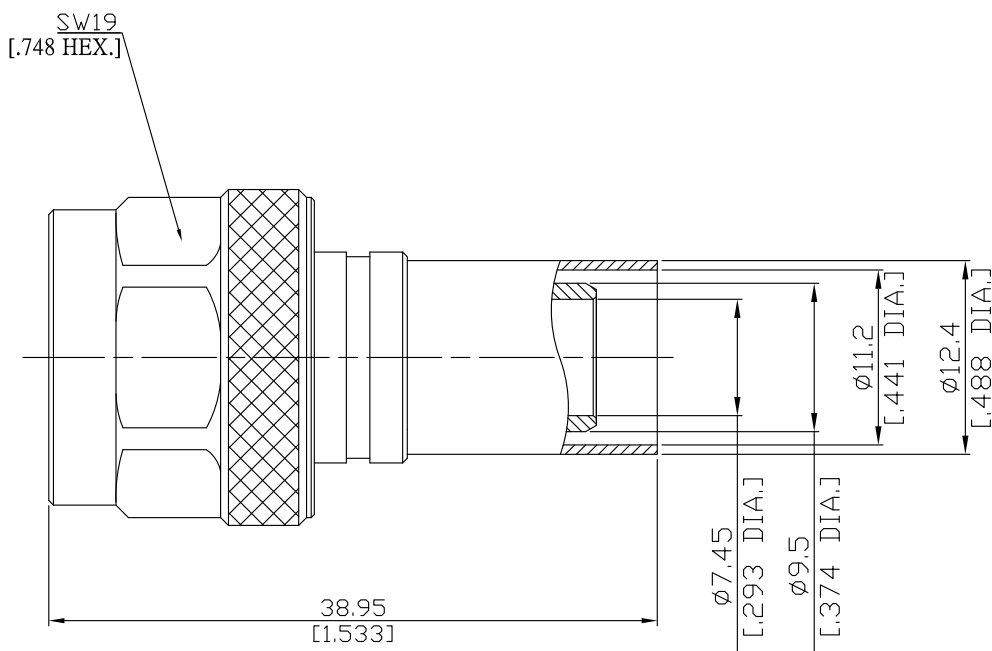

All dimensions are in mm [inch]

Tolerances according to DIN ISO 2768-mH

Interface

According to

IEC 61169-16

MIL-STD-348B/313

Electrical Data

Impedance

50 Ω

Frequency

DC to 6 GHz

VSWR (Return Loss)

≤ 1.22 (≥ 20 dB)

Insertion Loss

≤ 0.05 dB

Insulation Resistance

≥ 5 GΩ

Center Contact Resistance

≤ 1.0 mΩ

Outer Contact Resistance

≤ 0.25 mΩ

Working Voltage

500 V rms

Power handling (at 20 °C, sea level)

≤ 1000 W @ 1 GHz

≤ 700 W @ 2 GHz

- Limitations are possible due to the used cable type -

Material And Plating

Piece Parts	Material	Plating
Centre contact	Brass	Gold plating, 3 μinch (Non-magnetic nickel-phosphorus underplating, 80 μinch)
Body	Brass	Copper-Tin-Zinc Alloy
Insulator	PTFE	
Gasket	Silicone Rubber	
Coupling nut	Brass	Copper-Tin-Zinc Alloy
Ferrule	Brass	Copper-Tin-Zinc Alloy

The facts and figures herein are carefully compiled to the best of our knowledge, but they are intended for general informational purposes only. In the effort to improve our products, we reserve the right to make changes judged to be necessary.

Rev.:
Date:
12/7/2020

Rosnol RF/Microwave Technology Co., Ltd.
www.rosnol.com; info@rosnol.com
Phone: +886-3-463-5095 / Fax: +886-3-463-5952
N-CAGE Code: SFKK0 / ISO9001 Certified

Page
1/3

N Plug (Male) Connector Crimp/Contact Pin Solder or Crimp Attachment
for RG214, RG9, RG225, RG393 DC-6GHz VSWR1.22

N1C50-G214A / 144

Mechanical Data

Coupling Mechanisms	Screw-Lock
Mating Cycles	≥ 500
Coupling Test Torque	≤ 1.7 Nm
Recommended Torque	1.36 Nm
Centre Contact	Crimped or Soldered
Cable Entry	Crimped

Environmental Data

Temperature Range	-65°C to +165°C
Thermal Shock	MIL-STD-202, Method 107, Condition B
Corrosion	MIL-STD-202, Method 101, Condition B
Vibration	MIL-STD-202, Method 204, Condition B
Shock	MIL-STD-202, Method 213, Condition I
Moisture Resistance	MIL-STD-202, Method 106
RoHS	compliant

Suitable Cables

RG214, RG9, RG225, RG393

Weight

N/A

Packing

Single or 100

N Plug (Male) Connector Crimp/Contact Pin Solder or Crimp Attachment for RG214, RG9, RG225, RG393 DC-6GHz VSWR1.22

N1C50-G214A / 144

Connector Type:	N1C50-G214A/144	Inner Conductor Contact:	Soldered or Crimped
Suitable Cable:	RG214	Outer Conductor Contact:	Crimped

Parts List of Connector:

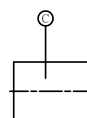
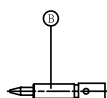
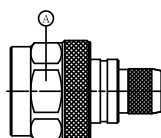

Crimped Ferrule
HEX. Crimp Size:



Crimped Contact Pin
HEX. Crimp Size:

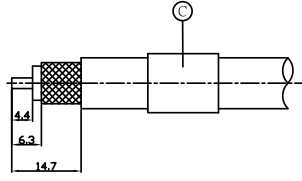
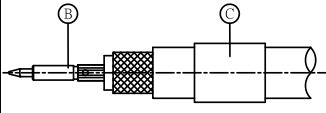
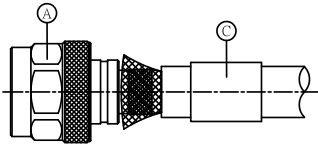
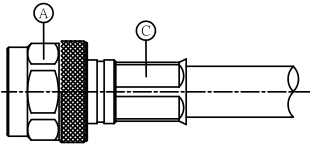

Assembly Steps:

Picture	Process	Attention/Check	Tools Required
	Push ferrule "C" over the cable. Prepare the cable according to the diagram.	Do not damage center contact, dielectric and braid.	Blade Scissor
	Push contact "B" over inner conductor of cable up to cable dielectric and crimp.	Contact "B" flush to dielectric.	Crimp tool: CT-L3 Crimp insert: CHL33KA
	Splay out braid and insert cable in connector body "A".	Ensure that braid lies above crimp neck.	
	Slide ferrule "A" over braid and crimp.	Crimp as close to connector body "C" as possible.	Crimp tool: CT-L3 Crimp insert: CHL33KA