

# N Straight Cable Plug

N1C50-G214A/000

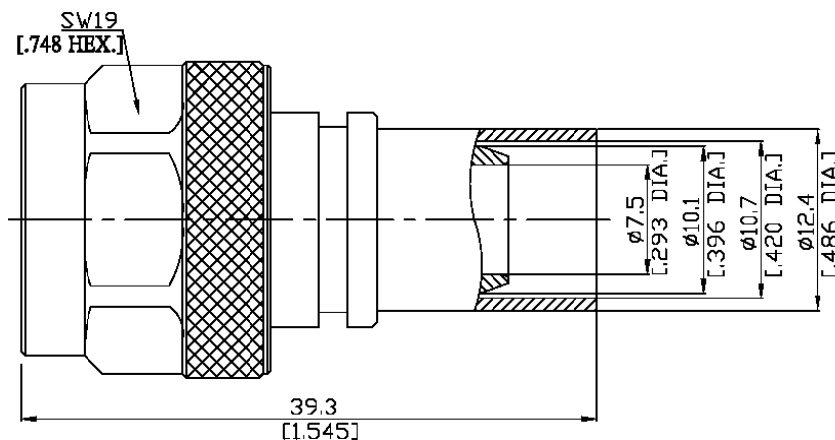

All dimensions are in mm [inch]

Tolerances according to DIN ISO 2768-mH

## Interface

According to MIL-C-39012; MIL-STD-348A/304

## Electrical Data

Impedance 50 Ω  
Frequency DC to 11 GHz  
VSWR (Return Loss) ≤ 1.08 (≥ 28.3 dB) @ 2GHz  
Insertion Loss ≤ 0.05  
Working voltage (at sea level) 3700 V rms

- Digressions are possible due to the used cable type and manufacturing process -

## Mechanical Data

Coupling mechanisms Screw-lock  
Centre contact Soldered  
Cable entry Crimped

## Environmental Data

Temperature range -65°C to +165°C  
RoHS compliant

## Material And Plating

Connector parts	Material	Plating
Centre contact	Brass	Silver
Body	Brass	Silver
Insulator	PTFE	
Gasket	Silicone Rubber	
Coupling nut	Brass	Silver
Crimp ferrules	Brass	Silver

## Suitable Cables

RG-214

## Packing

Single or 100