

MMCX Straight Cable Plug

MMCX1C50-G178A/11

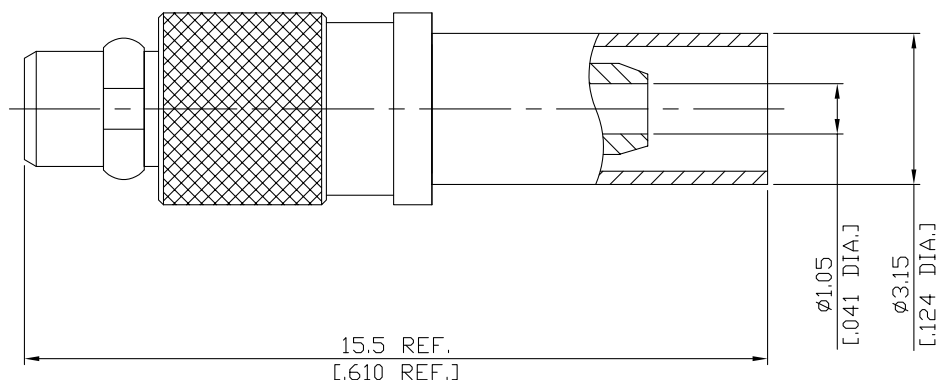

All dimensions are in mm [inch]

Tolerances according to DIN ISO 2768-mH

**Interface**

According to IEC 61169-52

**Electrical Data**

Impedance 50  $\Omega$   
Frequency DC to 6 GHz  
VSWR (Return Loss)  $\leq 1.22$  ( $\geq 20$ dB)  
Insertion Loss  $\leq 0.05$  dB

- Limitations are possible due to the used cable type -

**Mechanical Data**

Coupling mechanisms Snap-lock  
Centre contact Soldered  
Cable entry Crimped

**Environmental Data**

Temperature range -55°C to +155°C  
RoHS compliant

**Material And Plating**

Connector parts	Material	Plating
Centre contact	Brass	Gold plating(Nickel underplated)
Body	Brass	Gold plating(Nickel underplated)
Insulator	PTFE	
Crimp ferrules	Brass	Gold plating(Nickel underplated)

**Suitable Cables**

RG-178B, RG-196A

**Packing**

Single or 100