

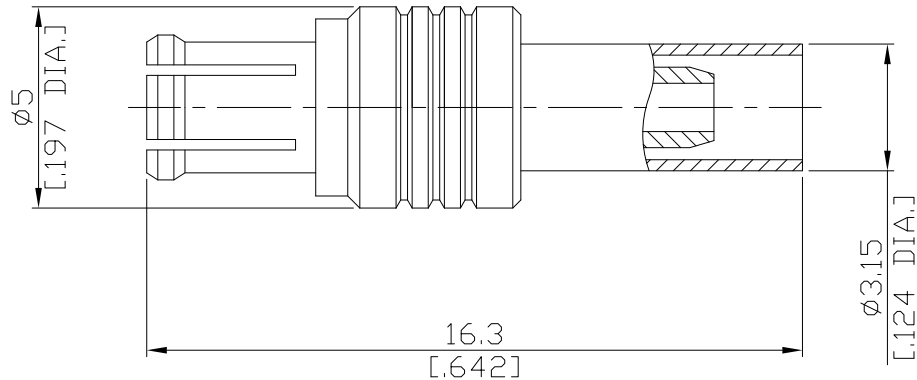

MCX Straight Cable Plug

MCX1C50-G178A/19



All dimensions are in mm [inch]
Tolerances according to DIN ISO 2768-mH

Interface

According to IEC 61169-36, CECC 22 220

Electrical Data

Impedance 50 Ω
Frequency DC to 6 GHz

- Limitations are possible due to the used cable type -

Mechanical Data

Coupling mechanisms Snap-lock
Centre contact Soldered/Crimped
Cable entry Crimped

Environmental Data

Temperature range -55°C to +155°C
RoHS compliant

Material And Plating

Connector parts	Material	Plating
Centre contact	Brass	Gold plating(Nickel underplated)
Outer contact		
Body	Beryllium Copper	Gold plating(Nickel underplated)
Insulator	PTFE	
Crimp ferrules	Brass	Gold plating(Nickel underplated)

Suitable Cables

RG 178, RG 196

Packing

Single or 100