

FME Straight Cable Plug

FME1C50-R200A/13

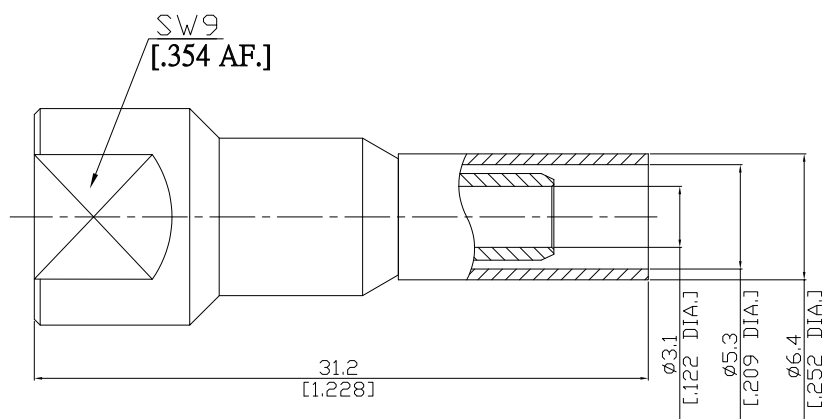

All dimensions are in mm [inch]

Tolerances according to DIN ISO 2768-mH

**Interface**

According to N/A

**Electrical Data**

Impedance 50 Ω

Frequency DC to 2.5 GHz

- Limitations are possible due to the used cable type and manufacturing process -

**Mechanical Data**

Coupling mechanisms Screw-lock

Centre contact Soldered; Crimped

Cable entry Crimped

**Environmental Data**

Temperature range -65°C to +165°C

RoHS compliant

**Material And Plating**

Connector parts	Material	Plating
Centre contact	Brass	Gold plating(Nickel underplated)
Body	Brass	Nickel
Insulator	PTFE	
Crimp ferrule	Brass	Nickel

**Suitable Cables**

LMR 200, BELDEN 7807A

**Packing**

Single or 100