

BMMA Jack (Female) Bulkhead Connector Solder Attachment Snap in Mount
for .085, DC-22 GHz, VSWR 1.35

BMMA2EA50-EZ085A / 9X

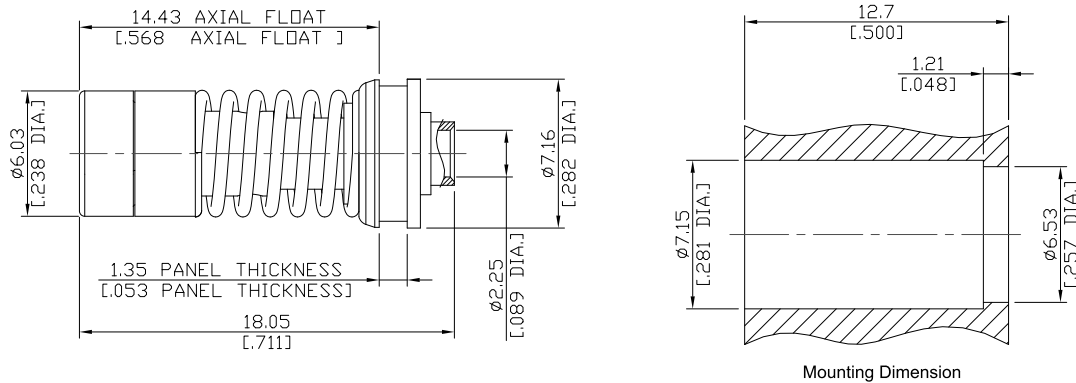

All dimensions are in mm [inch]

Tolerances according to DIN ISO 2768-mH

Interface

Mechanically compatible with
According to

OSSP and BMMA
MIL-STD-348

Electrical Data

Impedance	50 Ω
Frequency	DC to 22 GHz
VSWR (Return Loss)	≤ 1.35 (≥ 16.54 dB)
Insertion Loss	≤ 0.1 × √F (GHz) dB
Insulation Resistance	≥ 5 GΩ
Center Contact Resistance	≤ 3 mΩ
Outer Contact Resistance	≤ 0.5 mΩ
Dielectric Withstanding Voltage	675 Vrms

-VSWR in application depends decisive on cable assembly process-

Material And Plating

Piece Parts (BMA)	Material	Plating
Centre contact	Beryllium Copper	Gold plating (Non-magnetic nickel-phosphorus underplating)
Body	Stainless Steel	Passivated
Insulator	PTFE	

**BMMA Jack (Female) Bulkhead Connector Solder Attachment Snap in Mount
for .085, DC-22 GHz, VSWR 1.35**

BMMA2EA50-EZ085A / 9X

Mechanical Data

Coupling Mechanisms	Slide-on
Mating Cycles	≥ 5000
Centre contact	Plug-in
Cable entry	Soldered
Center Contact Retention	≥ 18 N
Engagement Force	max. 13.3 N
Disengagement Force	max. 6.7 N

Environmental Data

Temperature Range	-65°C to +165°C
Thermal Shock	MIL-STD-202, Meth. 107, Cond. B
Corrosion Resistance	MIL-STD-202, Meth. 101, Cond. B
Vibration	MIL-STD-202, Meth. 204, Cond. D
Shock	MIL-STD-202, Meth. 213, Cond. I
Moisture Resistance	MIL-STD-202, Meth. 106
RoHS	compliant

Suitable Cables

Semi-Rigid .085

Packing

Single or 100