

4.3-10 Female Connector Crimp/Solder Attachment for RG142, RG-58,
DC-6 GHz, VSWR ≤ 1.07

43102C50-G58A / H4

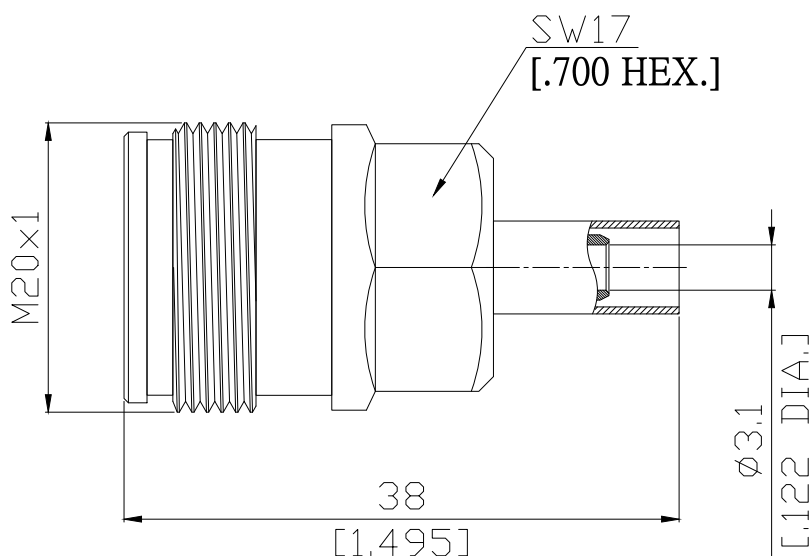

All dimensions are in mm [inch]

Tolerances according to DIN ISO 2768-mH

Interface

4.3/10 according to

IEC 61169-54

Electrical Data

Impedance	50 Ω
Frequency	DC to 6 GHz
VSWR (Return Loss)	≤ 1.07 (≥ 30 dB)
Insertion Loss	≤ 0.08 dB
Insulation Resistance	≥ 5 GΩ
Center Contact Resistance	≤ 1.0 mΩ
Outer Contact Resistance	≤ 0.5 mΩ
Test Voltage (at sea level)	1000 V rms
Power Handling	500 W @ 2 GHz

- Limitations are possible due to the used cable type -

Material And Plating

Piece Parts (4.3-10)	Material	Plating
Centre contact	Phosphor Bronze	Gold plating, 3 μinch (Non-magnetic nickel-phosphorus underplating, 80 μinch)
Body	Brass	Copper-Tin-Zinc Alloy
Insulator	PTFE	

4.3-10 Female Connector Crimp/Solder Attachment for RG142, RG-58, DC-6 GHz, VSWR≤ 1.07

43102C50-G58A / H4

Mechanical Data

Coupling mechanisms	Screw-lock
Mating cycles	min. 100
Center contact captivation: axial	> 30 N
radial	> 5 Ncm
Center contact retention force	1.5 - 20 N
Outer contact retention force	4 - 35 N
Recommended torque	5 Nm

Environmental Data

Temperature Range	-55°C to +90°C
RoHS	compliant

Packing

Single or 100