

4.3-10 Male Connector Crimp/Solder Attachment for RG142, RG-223

43101C50-G142A / 144

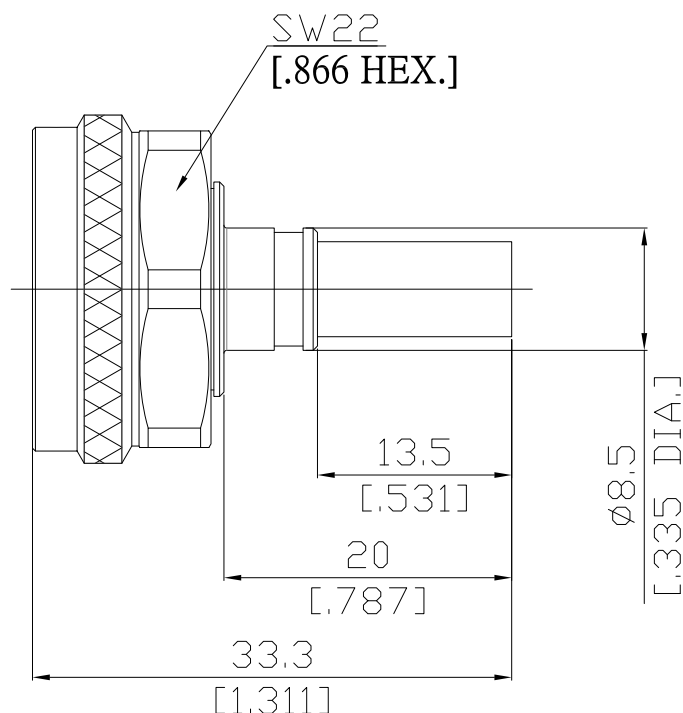

All dimensions are in mm [inch]

Tolerances according to DIN ISO 2768-mH

Interface

4.3/10 according to

IEC 61169-54

Electrical Data

Impedance	50 Ω
Frequency	DC to 6 GHz
VSWR (Return Loss)	≤ 125 (≥ 32 dB)
Insertion Loss	≤ 0.05 × √F (GHz) dB
Insulation Resistance	≥ 5 GΩ
Center Contact Resistance	≤ 1.0 mΩ
Outer Contact Resistance	≤ 1.0 mΩ
Test Voltage (at sea level)	2500 V rms
Working Voltage (at sea level)	500 V rms
RF Leakage	≥ 110 dB @ DC to 6 GHz
Power Handling	500 W @ 2 GHz
Intermodulation (3rd order)	≥ 166 dBc (2 x 43 dBm) @ 0.4-4.0 GHz

- Limitations are possible due to the used cable type -

Material And Plating

Piece Parts (4.3-10)	Material	Plating
Centre contact	Brass	Gold plating, 3 μinch (Non-magnetic nickel-phosphorus underplating, 80 μinch)
Body	Brass	Copper-Tin-Zinc Alloy
Insulator	PTFE	
Coupling nut	Brass	Copper-Tin-Zinc Alloy

The facts and figures herein are carefully compiled to the best of our knowledge, but they are intended for general informational purposes only. In the effort to improve our products, we reserve the right to make changes judged to be necessary.

Rev.:
Date: JUL/16/2021

Rosnol RF/Microwave Technology Co., Ltd.
www.rosnol.com; info@rosnol.com
Phone: +886-3-463-5095 / Fax: +886-3-463-5952
N-CAGE Code: SFKK0 / ISO9001 Certified

Page

1/2

4.3-10 Male Connector Crimp/Solder Attachment for RG142, RG-223

43101C50-G142A / 144

Mechanical Data

Coupling mechanisms	Screw-lock
Mating cycles	min. 100
Center contact captivation: axial	> 30 N
radial	> 5 Ncm
Center contact retention force	1.5 - 20 N
Outer contact retention force	4 - 35 N
Recommended torque	5 Nm

Environmental Data

Temperature Range	-55°C to +90°C
RoHS	compliant

Packing

Single or 100