

**SMA (RP female) Reverse Polarity Straight  
Bulkhead Cable Crimp Jack**

**SMA7CA50-G058A/14**

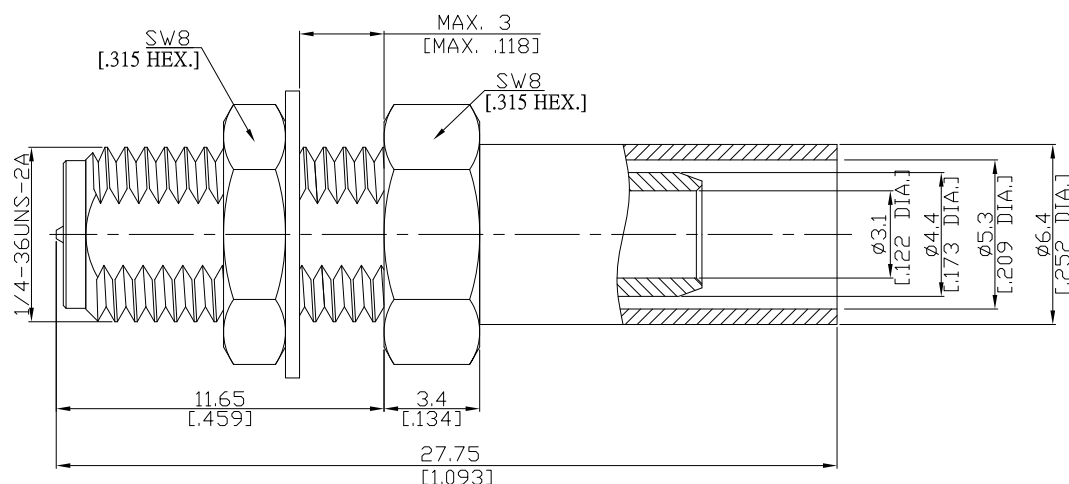

All dimensions are in mm [inch]

Tolerances according to DIN ISO 2768-mH

**Interface**

According to IEC 60169-15; MIL-STD-348B/310

**Electrical Data**

Impedance 50 Ω

Frequency DC to 6 GHz

- Limitations are possible due to the used cable type and manufacturing method -

**Mechanical Data**

Coupling mechanisms Screw-lock

Centre contact Soldered and Crimped

Cable entry Crimped

**Environmental Data**

Temperature range -65°C to +165°C

RoHS compliant

**Material And Plating**

Connector parts	Material	Plating
Centre contact	Brass	Gold plating(Nickel underplated)
Body	Brass	Copper-Tin-Zinc Alloy
Insulator	PTFE	
Crimp ferrules	Brass	Copper-Tin-Zinc Alloy
Fastening nut	Brass	Copper-Tin-Zinc Alloy
Washer	Brass	Copper-Tin-Zinc Alloy

**Suitable Cables**

RG58, RG58A, RG58C, RG141, RG303, BELDEN 7806A, BELDEN 9907, LMR 195, RNL-195

**Packing**

Single or 100

**Related Document**

Mounting Dimension MD19

SMA (RP female) Reverse Polarity Straight  
Bulkhead Cable Crimp Jack

SMA7CA50-G058A/14

**Crimp Dimensions [HEX]**

Crimp ferrule	5.41mm [.213 inch]
Centre contact	1.73mm [.068 inch]