

SMA Right Angle Panel Receptacle Jack  
(Coaxial End)

SMA2GTA59-1740B/91

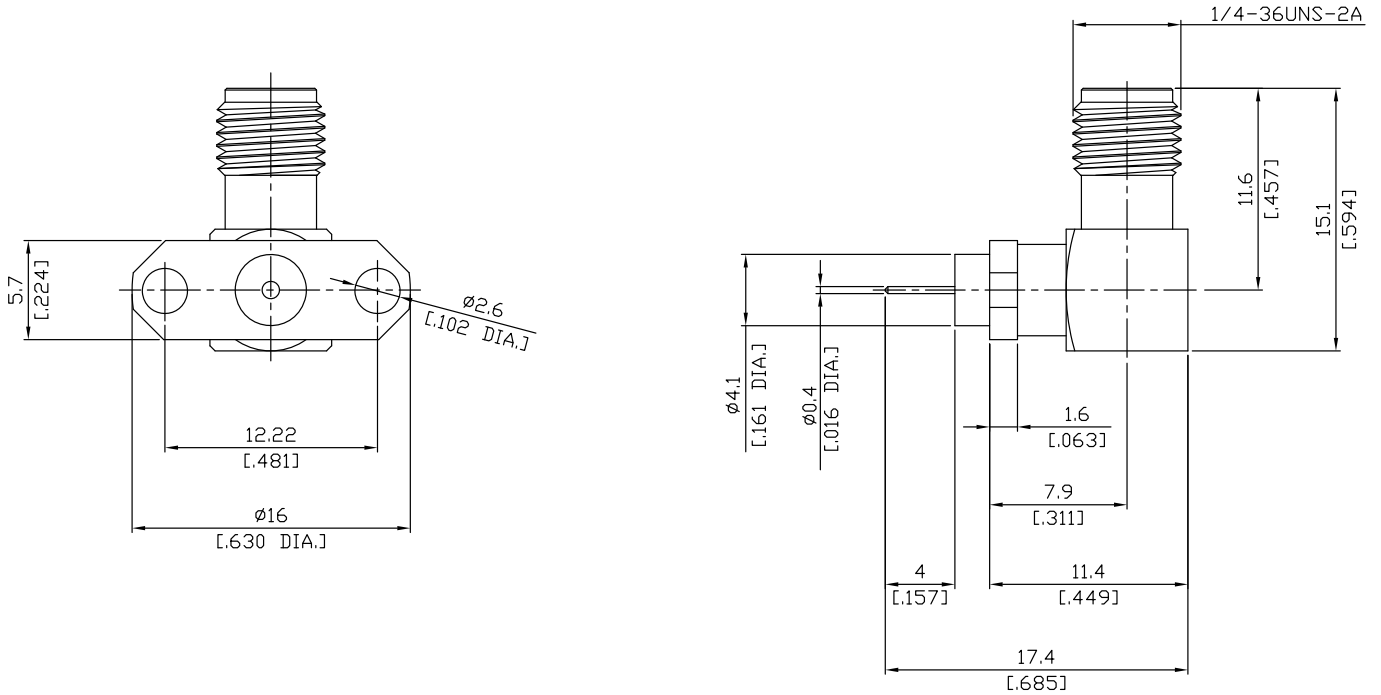

All dimensions are in mm [inch]  
Tolerances according to DIN ISO 2768-mH

**Interface**  
According to MIL-C-39012;MIL-STD-348A/310

**Electrical Data**  
Impedance 50 Ω  
Frequency DC to 27 GHz

**Mechanical Data**  
Coupling mechanisms Screw-lock  
Weight 0.0052 kg

**Environmental Data**  
Temperature range -65°C to +165°C  
RoHS compliant

Material And Plating		
Piece Parts	Material	Plating
Centre contact	Beryllium Copper	Gold plating(Nickel underplated)
Body	Brass	Gold plating(Nickel underplated)
Insulator	PTFE	

**Packing**  
Single or 100

**Related Document**  
Mounting Dimension MD75